

# Style Safe 5200

Formerly marketed as Phoenix 5200

**HÖRMANN**

## BETTER



Door: Ltd Lifetime



Hardware: 6 yr



Springs: 3 yr

- **R-10.5** Thermal Rating
- Steel Construction
- 2" Sections
- White + Custom Colors
- 6 Panel Designs
- 6 Window Designs

### Thermal Rating



### Customizations



### Low Maintenance



### Luxury Level



## PANEL DESIGN OPTIONS

**1** Gilbert

**2** Mesa I\*

**3** Chandler II\*

**4** Tempe II\*

**5** Scottsdale

**6** Glendale

\*More designs available

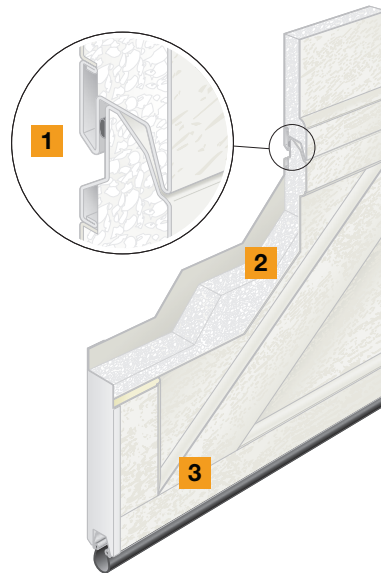
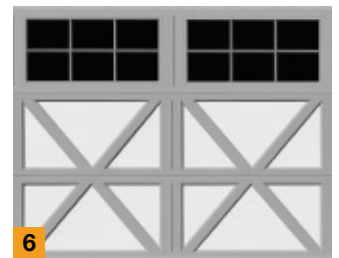
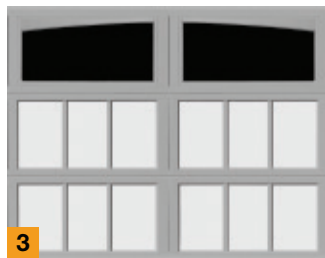

### Deep Tongue and Groove **1**

Section joints contribute to the door's excellent strength. Intermediate seals prevent air infiltration, which enhances the insulation properties.

### 3-Layer Sandwich Construction **2**

Steel front and back construction with insulating polystyrene core increases energy savings and provides a very smooth and quiet operation.

### Well-defined Panel Designs **3**

Carriage house inlay designs with easy to clean Rainslope™ woodgrain texture, galvanized and finish painted steel provide years of trouble-free performance and beauty.

## Hörmann Innovations

### FingerGuard™ Pinch Resistant

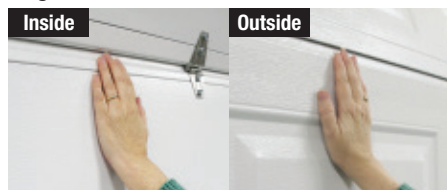

The FingerGuard™ section joints and hinges provide an air-tight seal and prevent finger injuries both inside and outside.

### Between Section & Side Seals



Factory installed between section weather seals and side seals offer maximum protection from the outside elements while further enhancing the insulation properties of a door.

### White 11 Ball Bearing Nylon Rollers

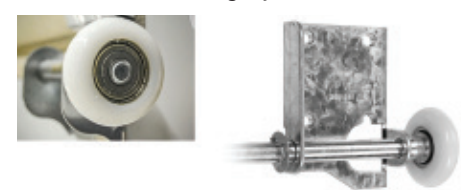

Hörmann nylon rollers feature 11 pre-lubed ball bearings encased in a high strength steel casing that provides a quiet ride and years of reliable service.

## COLOR OPTIONS

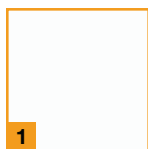

- 1 White
- 2 Galaxy Paint (Custom Color)

\* Color application method will be at the discretion of the manufacturer.

All colors shown as accurately as printing technology allows.



## WINDOW DESIGN OPTIONS



Non-insulated and insulated glasses are available along with solid door (no glass).

- 1 Glazed 1 pane
- 2 Glazed arch 1 pane
- 3 Glazed 3 pane
- 4 Glazed arch 3 pane
- 5 Glazed 6 pane
- 6 Glazed arch 6 pane

## DECORATIVE HARDWARE OPTIONS

Enhance the look of your garage door with our attractive powder coated hardware of decorative hardware kits.

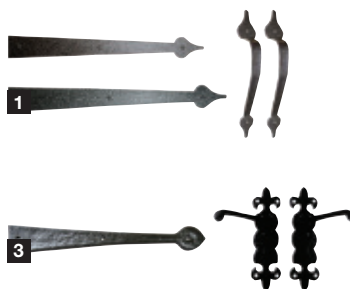

- 1 Spade - Stamped Steel
- 2 Spear - Wrought Iron
- 3 Elegant Handle



### Call toll free

Eastern & Central US: 877.654.6762  
Western US: 800.522.2264  
Canada: 833.743.2443

### Contact

Email: [info@hormann.us](mailto:info@hormann.us)  
Website: [hormann.us](http://hormann.us)



Follow us on social media



We reserve the right to change specifications without notice. ©Hörmann (07/14/2025)

PN 27775144

### AVAILABLE FROM:

